 VALENCIA BIOMEDICAL RESEARCH FOUNDATION CENTRO DE INVESTIGACIÓN PRÍNCIPE FELIPE	<b>MANUAL</b>		<b>B100-M-02</b>
	VPN (MFA) – DARWIN – REMOTE DESKTOP		
	Nº edition: 05		Page 1 of 12



VALENCIA BIOMEDICAL RESEARCH FOUNDATION  
CENTRO DE INVESTIGACIÓN PRÍNCIPE FELIPE

## I.T. DEPARTMENT

### CONTENT:

- **VPN + (MFA: MULTI-FACTOR AUTHENTICATION) (pag. 2)**
- **CONNECT TO DARWIN (pag. 7)**
- **REMOTE DESKTOP CONNECTION (pag. 10)**

## VPN + (MFA: MULTI-FACTOR AUTHENTICATION)

1

Access the portal page with your CIPF credentials

<https://vpn.cipf.es>

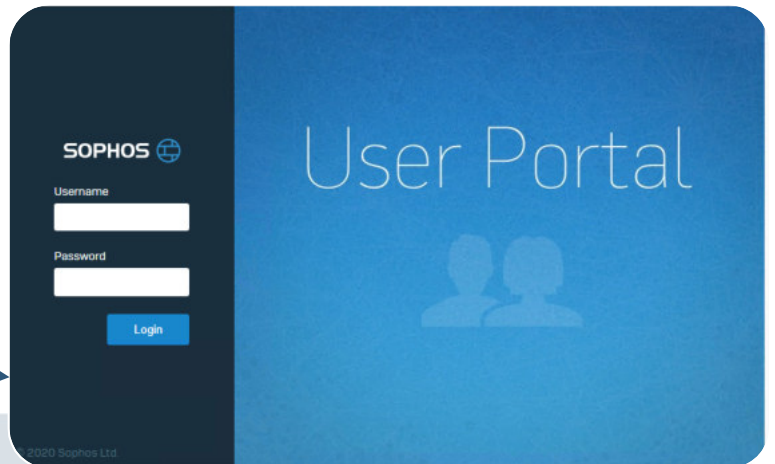

2

Install one of these two APPs on your mobile phone.



Microsoft Authenticator



[Get APP](#)



[Get APP](#)



Google Authenticator



[Get APP](#)



[Get APP](#)

If this is the first time you access the USER PORTAL, you will see the following

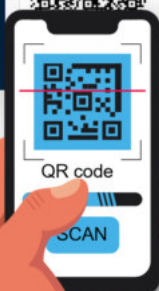
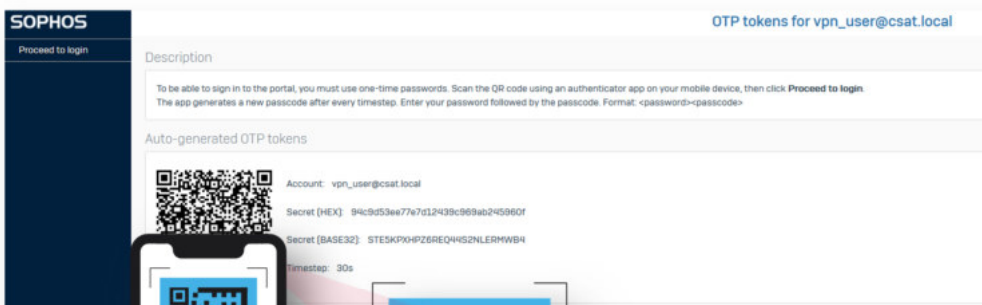

Scan the QR code with the previously installed APP

3

**4**

Click on **Proceed to login** to return to the VPN PORTAL.

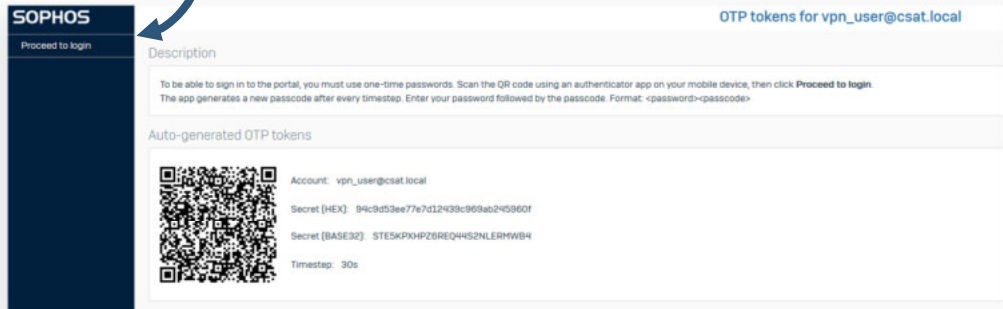

**5**

From the **authentication APP**, click on your user's profile to generate an **access code**.

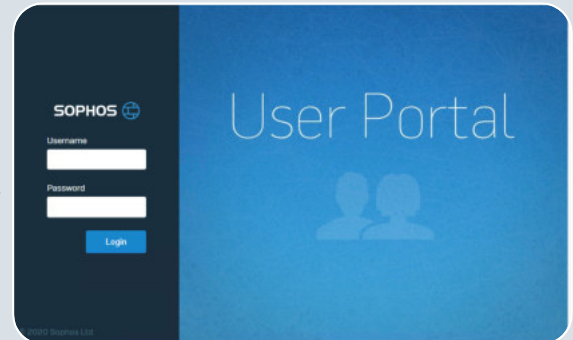

Access the portal with your **CIPF** username and **password** followed by the generated **access code**.

Example:

**Username:** cipfusername

**Password:** cipfpassword**711725**

6

### Windows only

Once inside the VPN user portal, you will need to download the "**Sophos Connect Client**" version and install it.

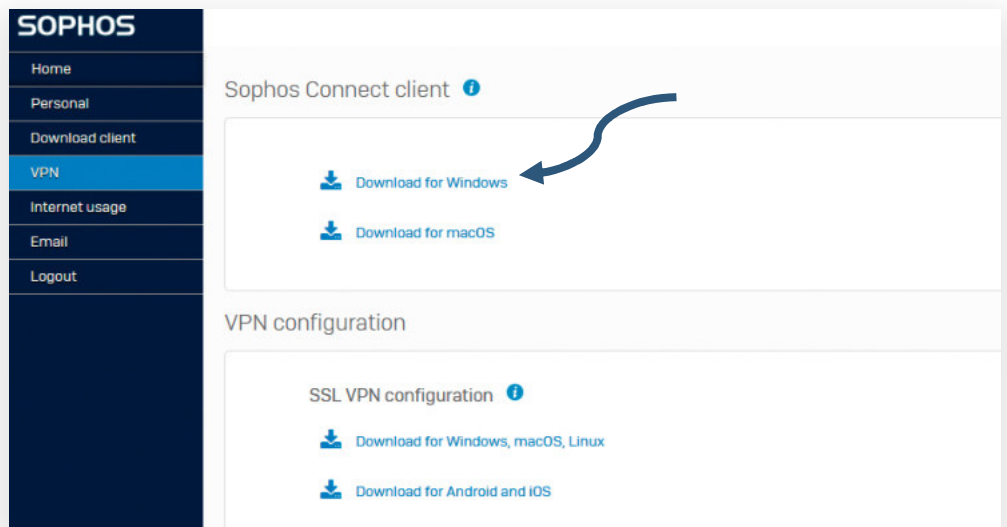

### MAC only

Download the **TunnelBlick** software and install it.  
<https://tunnelblick.net/>

Then, download the "**SSL VPN configuration**" version corresponding to your Operating System.

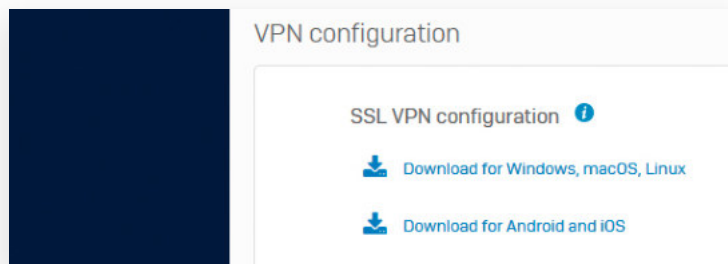

**7**

**Import the "SSL VPN configuration" file to the VPN client**

```
cipfuser@csat.local-client-config.ovpn
```

**Windows only**

Open "**Sophos Connect Client**". In Import connection select the previous file.

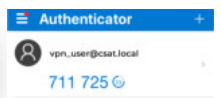
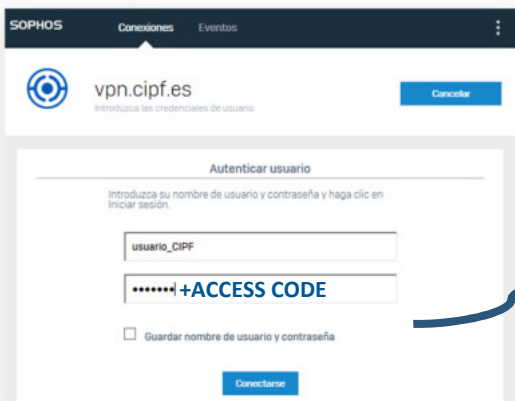
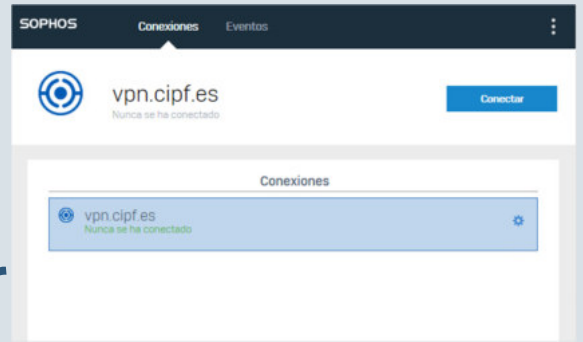
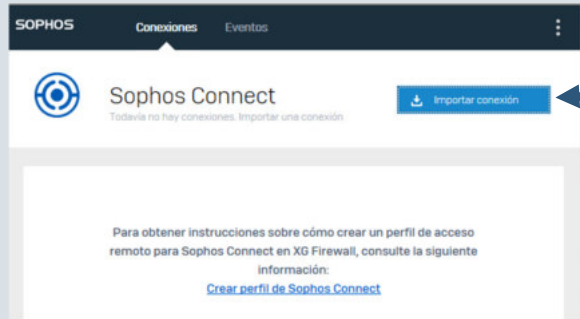

Example:  
**Username:** cipfusername  
**Password:** cipfpassword711725

**MAC only**

Open the **TunnelBlick** application and drag the previously downloaded file to the application icon at the top.

`cipfuser@csat.local-client-config.ovpn`

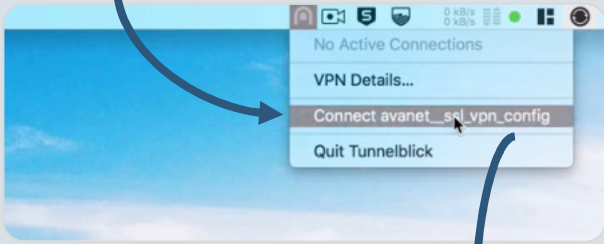

Example:  
**Username:** cipfusername  
**Password:** cipfpassword711725

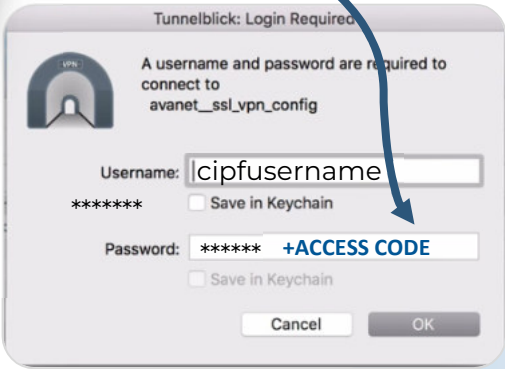

## CONNECT TO DARWIN

Windows only

1

Open the file explorer and right-click on This PC, then click on Map network drive

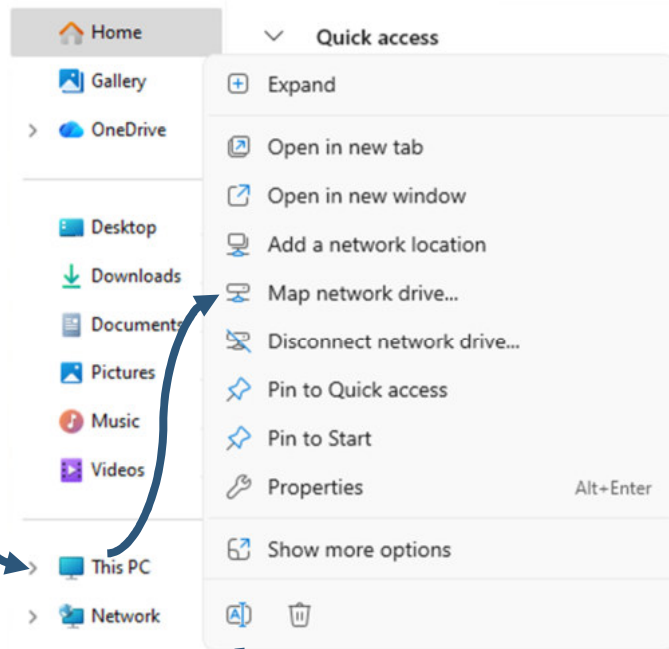

2

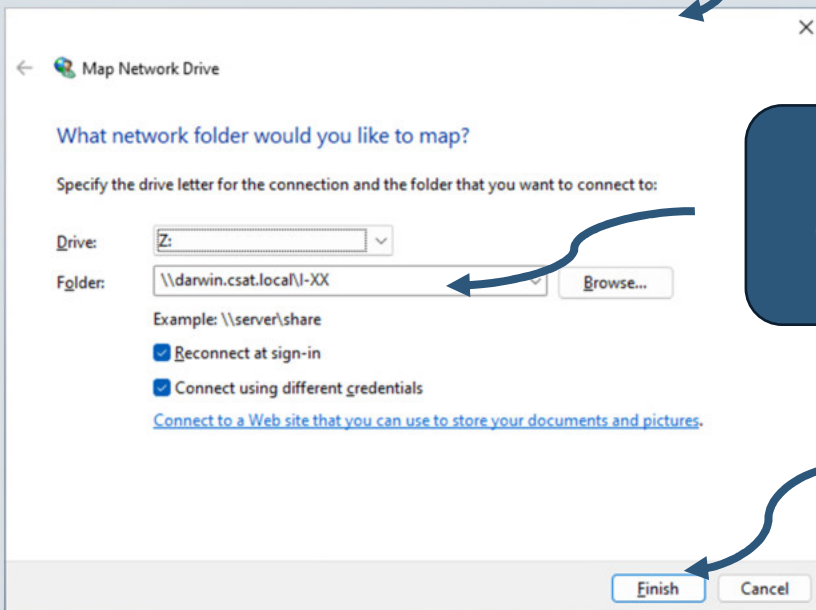

\\darwin.csat.local\I-XX

(where I-XX we will replace it with the group or department)

Check the two lower boxes and click Finish

**3**

**Enter your CIPF user credentials and click **Accept****

**USERNAME: csat\cipfusername**  
**PASSWORD: cipfpassword**

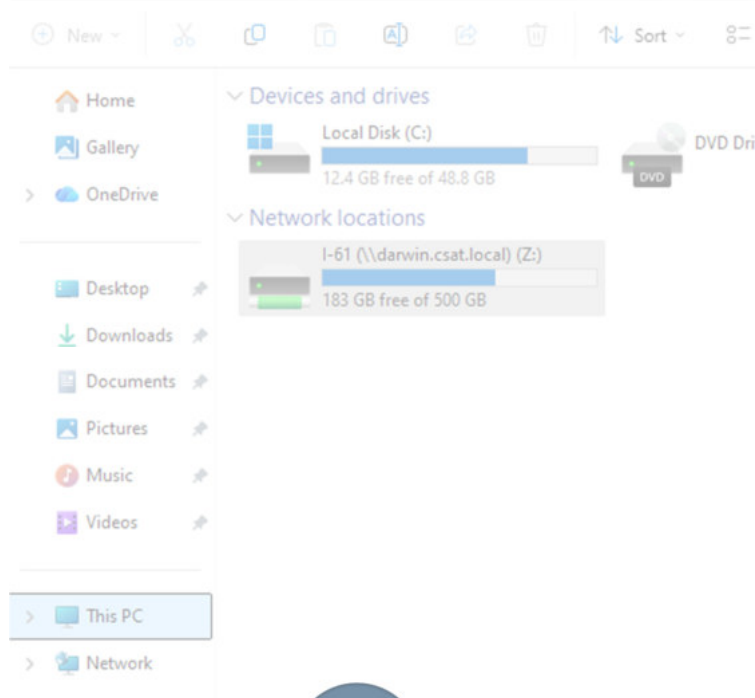
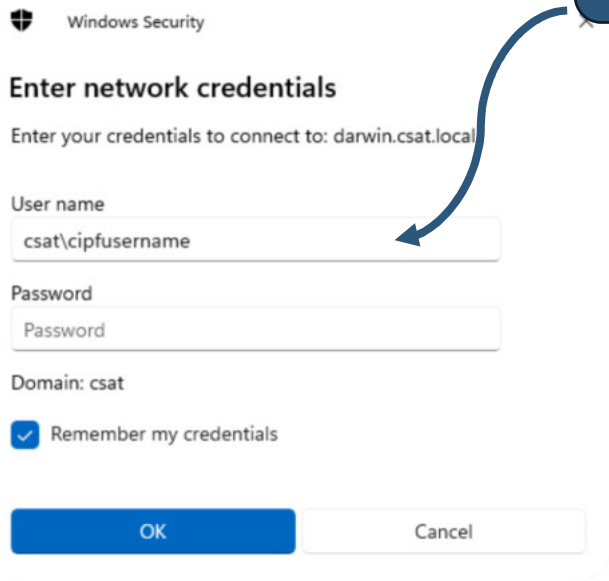

**MAC only**

**in Finder click the **Go** menu and select "**Connect to Server...**" at the bottom of the menu**

**1**

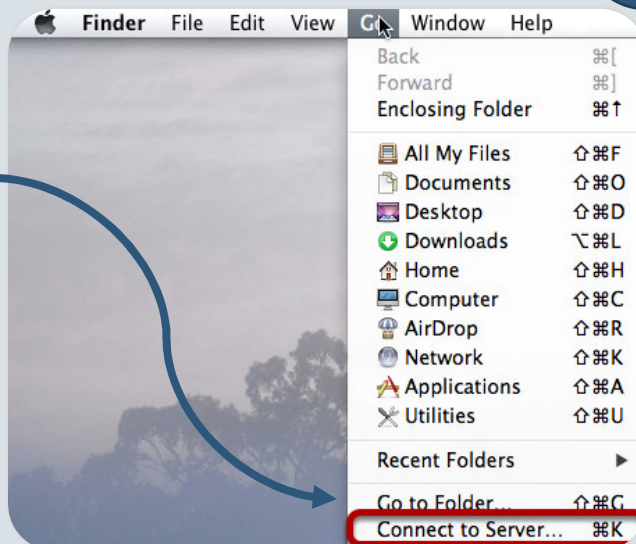

2

**smb://darwin.csat.local/I-XX**  
 (where I-XX we will replace it with the group or department)

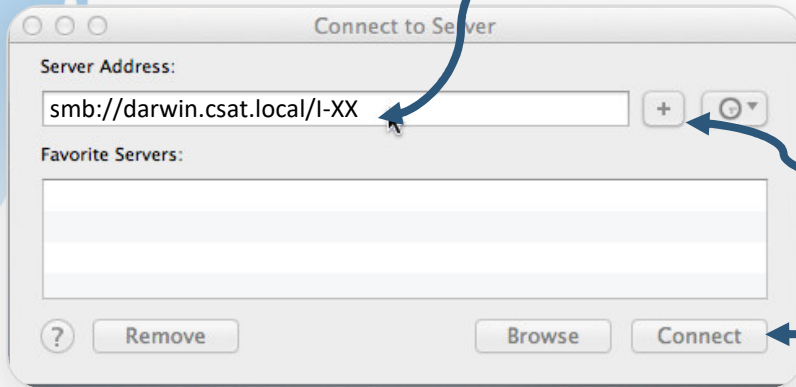

Press + to save it  
 in 'Favorite  
 Servers' and then  
 'Connect'

USERNAME: **csat\cipfusername**  
 PASSWORD: **cipfpassword**

3

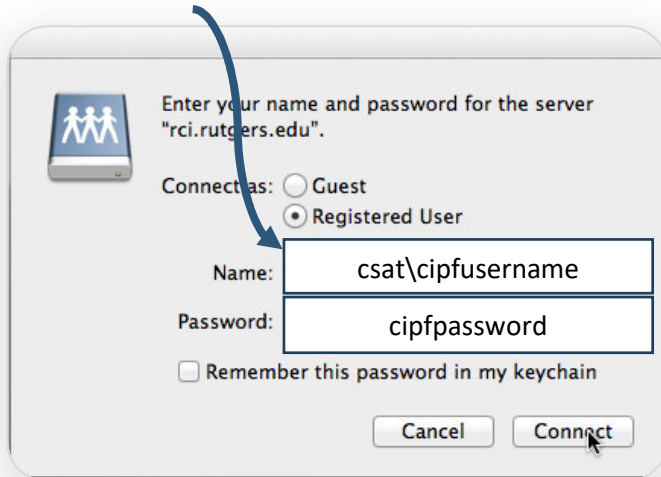

## REMOTE DESKTOP CONNECTION

1

Windows only

In the **Windows search bar**, type **'desktop'** and click on the **first result**

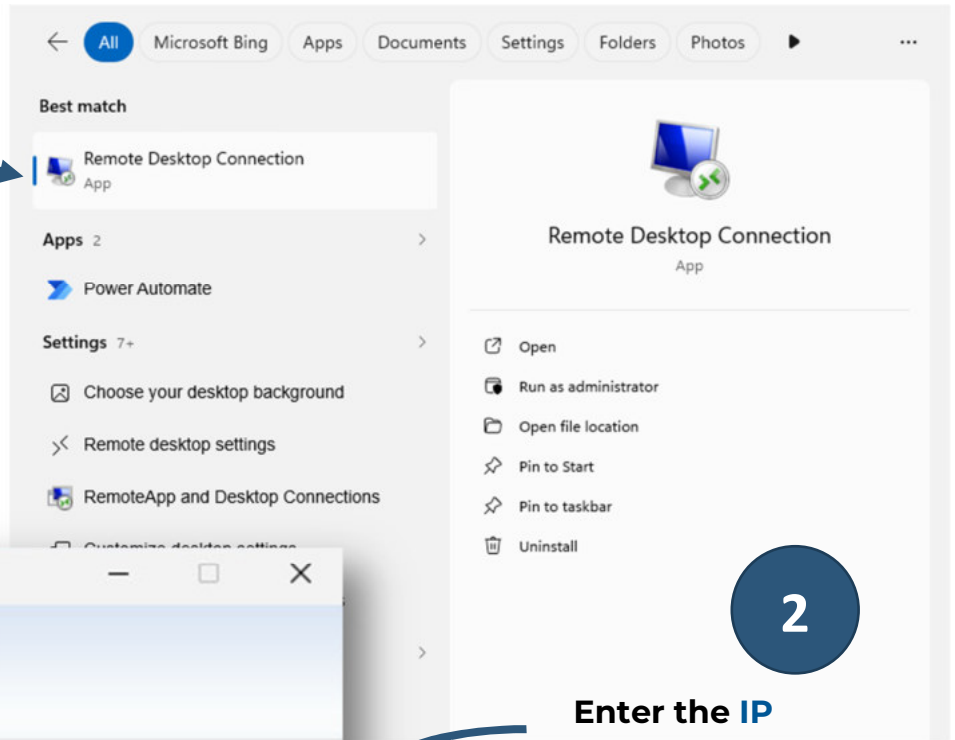

2

Enter the **IP address or the PC Name** and click on **Connect**

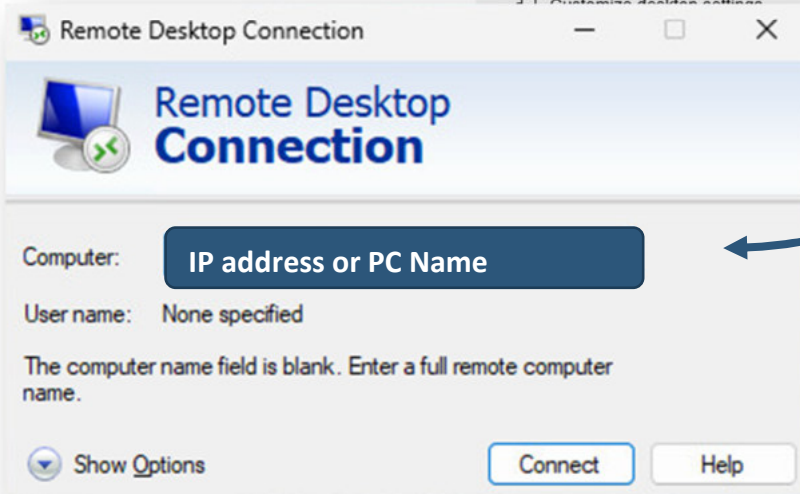

3

Enter your **CIPF user credentials** and click **Accept**

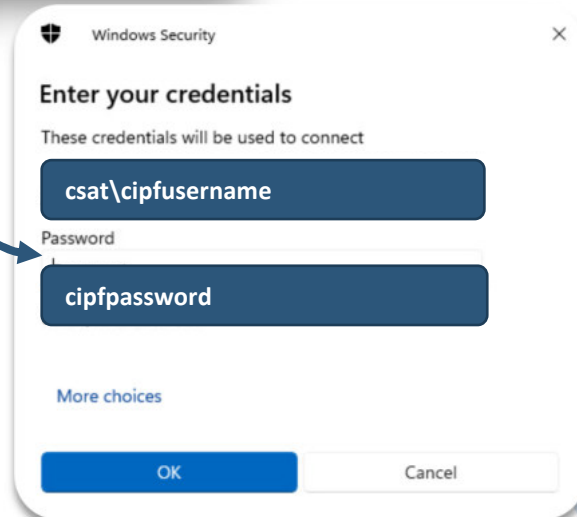

**1**

**MAC only**

**Download and install the Windows App from the App Store**

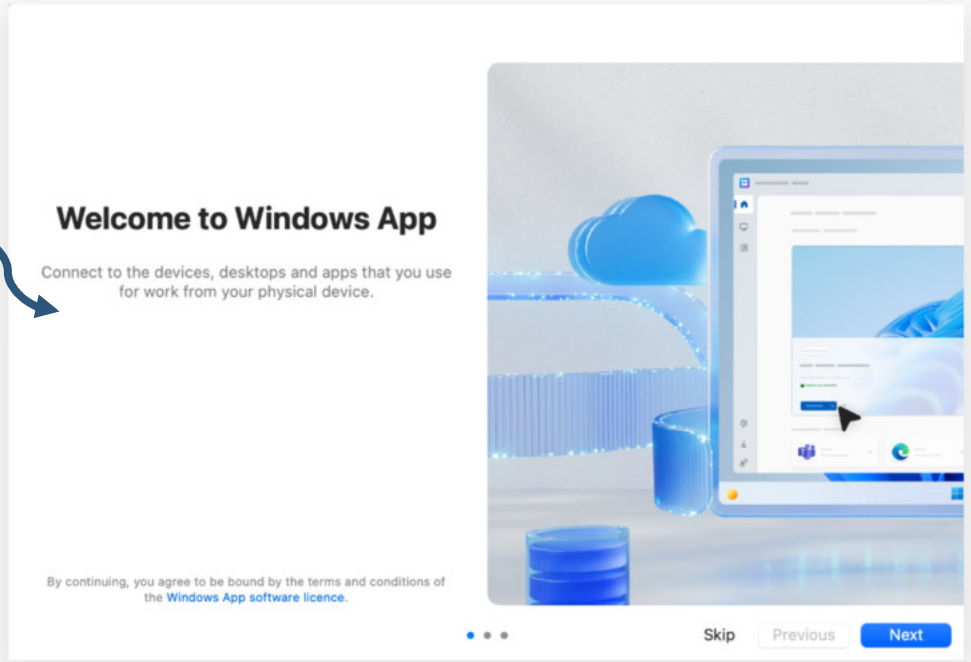

**2**

**Go to devices, click on + and Add PC**

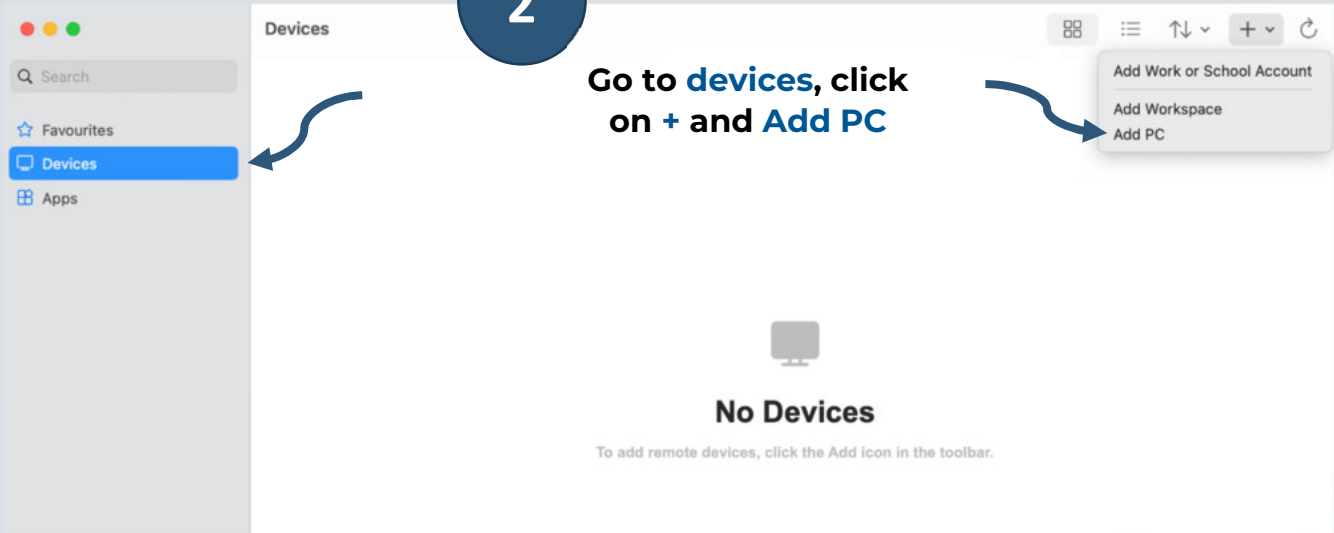

**3**

**Enter the Name or IP Address of the remote computer and press Add**

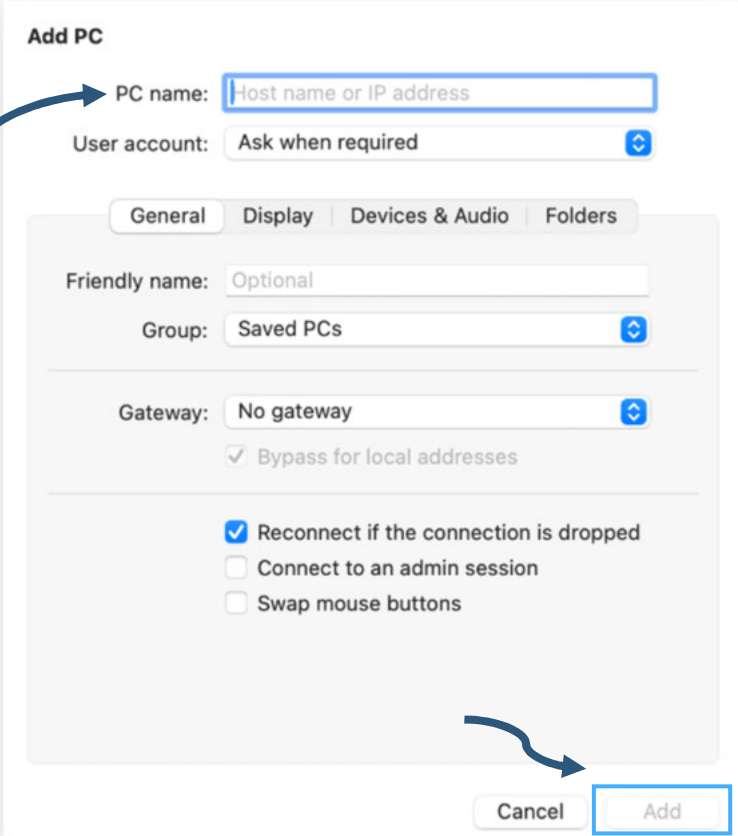

**4**

**Double Click on the device that has been added**

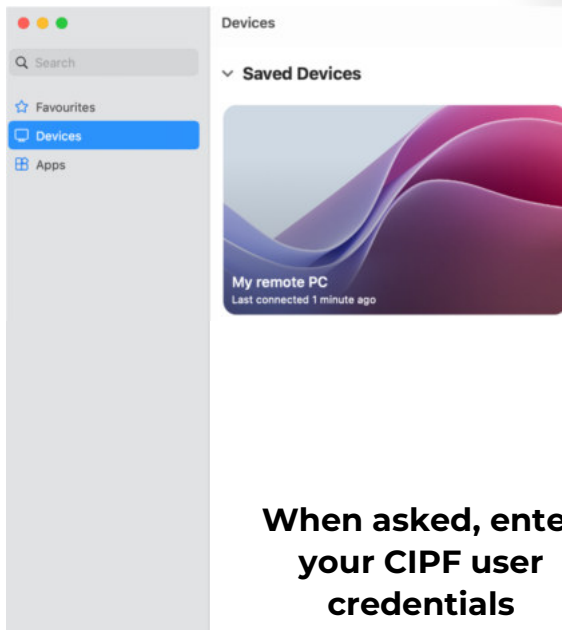

**When asked, enter your CIPF user credentials**

**5**

**USERNAME: csat\cipfusername**  
**PASSWORD: cipfpassword**